

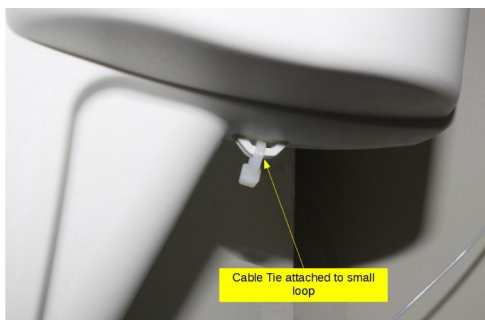
## Sample Line, 4000

If you have not read the General Plumbing Instructions (11781) for replacing plumbing parts on the KinExA® Instrument please do so now before continuing.

The following Parts and/or Tools are required to complete this installation:

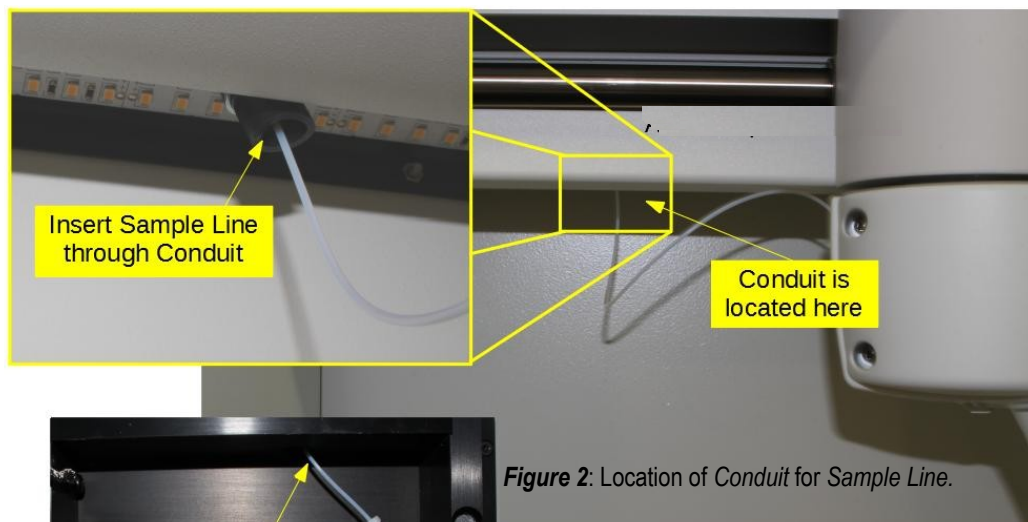
- |                                     |                                      |
|-------------------------------------|--------------------------------------|
| [1] Sample Line, 4000 (344480)      | [2] 1/16" Tan 10-32 Ferrule (347113) |
| [1] 1/4" Deep Socket (015902)       | [1] Extra Short Nut (346205)         |
| [1] 15 in-oz Torque Wrench (024140) | [1] Short Nut (346204)               |
| [1] 4 in Cable Tie (619104)         |                                      |

- Use a 4" Cable Tie (619104) to make a small loop as shown in **Figure 1**.  
**Note:** This step only needs to be completed if the Instrument is new, otherwise use existing Cable Tie loop. If a new one is placed, clip the excess Cable Tie so it is flush with the base.

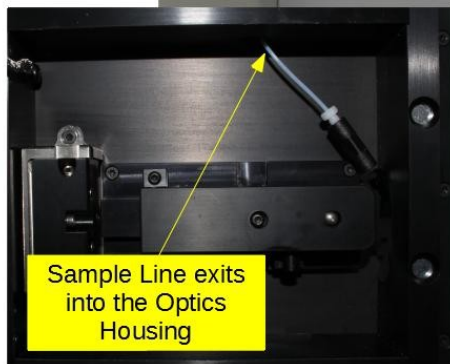


**Figure 1:** Orientation of Cable Tie through the loop.

- Starting from inside the Instrument, feed the Sample Line through the conduit until it protrudes into the Optics Housing as shown in **Figures 2 & 3**.



**Figure 2:** Location of Conduit for Sample Line.

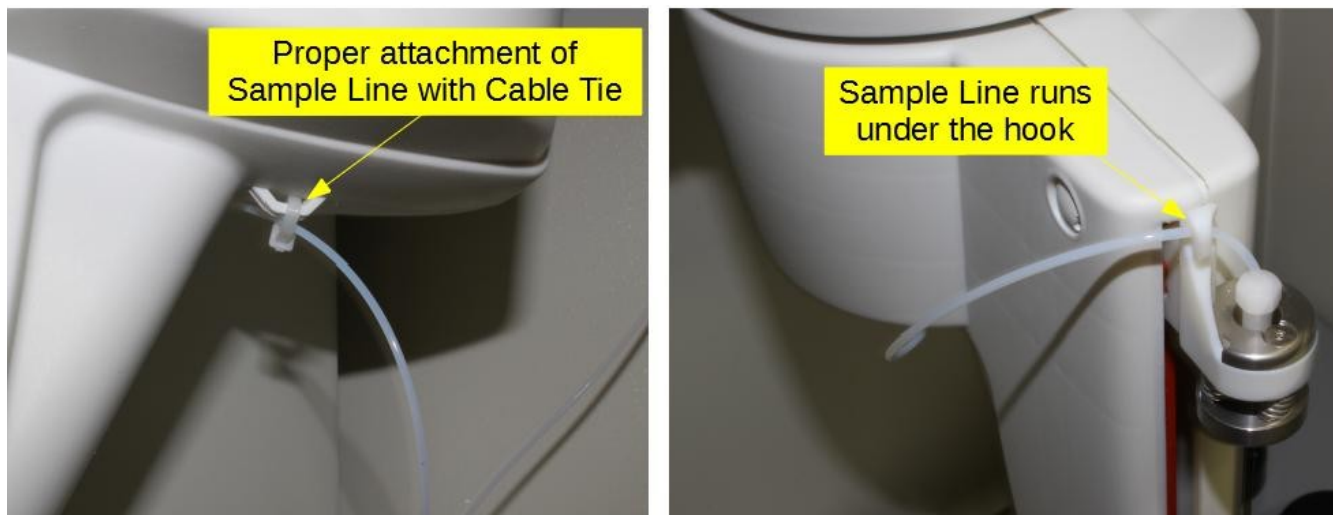


**Figure 3:** Proper exit of the Sample Line into the Optics Housing.

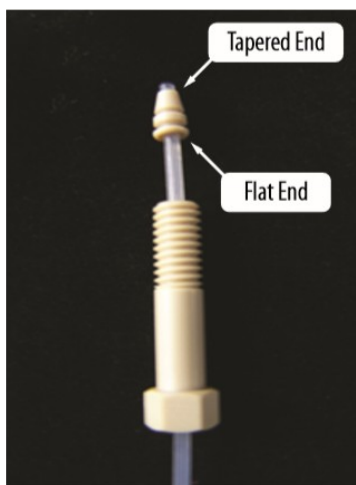
# Sample Line, 4000

**Note:** For guidance on the orientation of *Ferrules*, see *Figure 5*.

- Attach the *Sample Line* to one side of the *Union* using the *Extra Short Nut* (346205) and the 1/16" *Tan 10-32 Ferrule* (347113) (included with the *Sample Line*). Torque the *Extra Short Nut* using the 1/4" *Deep Socket* (015902) and the 15 in-oz *Torque Wrench* (024140).
- Pull the *Sample Line* through the *Cable Tie* loop, moving from right to left so that the *Sample Line* is on the left side of the *Autosampler Arm*. Make sure the *Sample Line* is positioned under the tubing hook just above the *Sipper Tube* as seen in *Figure 4*. Attach the *Sample Line* to the top of the *Sipper Tube* using the *Short Nut* (346204) and the 1/16" *Tan 10-32 Ferrule* (included with the *Sample Line*) and torque the *Short Nut* using the 1/4" *Deep Socket* and the 15 in-oz *Torque Wrench*.



**Figure 4:** *Sample Line* correctly routed through the *Cable Tie* and under the tubing hook.



**Figure 5:** *Tan Ferrule* with tapered end away from *Nut*.